



# CROSS KEYS

- HOUSE -

A close-up photograph of the stone entrance to Cross Keys House. The name 'CROSS KEYS HOUSE' is carved in large, bold, serif capital letters into a recessed rectangular panel of the stone. The stone is a light tan color with some weathering and discoloration. Above and below the panel are decorative carvings of acanthus leaves and scrolls.

CROSS KEYS HOUSE

**PRIME CENTRAL OFFICE SPACE IN  
THE HEART OF SALISBURY**



22 Queen Street, Salisbury  
[www.crosskeyssalisbury.co.uk](http://www.crosskeyssalisbury.co.uk)

# OFFICES AVAILABLE ON FLEXIBLE TERMS.

Cross Keys is a Grade II listed property well positioned in the heart of Salisbury with fantastic views over the Guildhall Square.

The accommodation is arranged as individual office suites, which may be combined as larger open plan offices.

The entrance to Cross Keys House leads from Queen Street and is served by two lifts providing access to all floors.

The offices attract entrepreneurial businesses benefiting from the following features:

- Category II lighting
- Suspended ceilings
- Perimeter trunking
- Central heating
- Fitted carpets
- Kitchen facilities
- Male/female/disabled WCs

- ✓ **CENTRAL OFFICE LOCATION**
- ✓ **ONSITE CAR PARKING AVAILABLE**
- ✓ **HIGH QUALITY SERVICED OFFICES**
- ✓ **FLEXIBLE TERMS**
- ✓ **SPACIOUS & ADAPTABLE**
- ✓ **CLOSE TO ALL AMENITIES**



# OFFICE UNITS AVAILABLE TO LET.

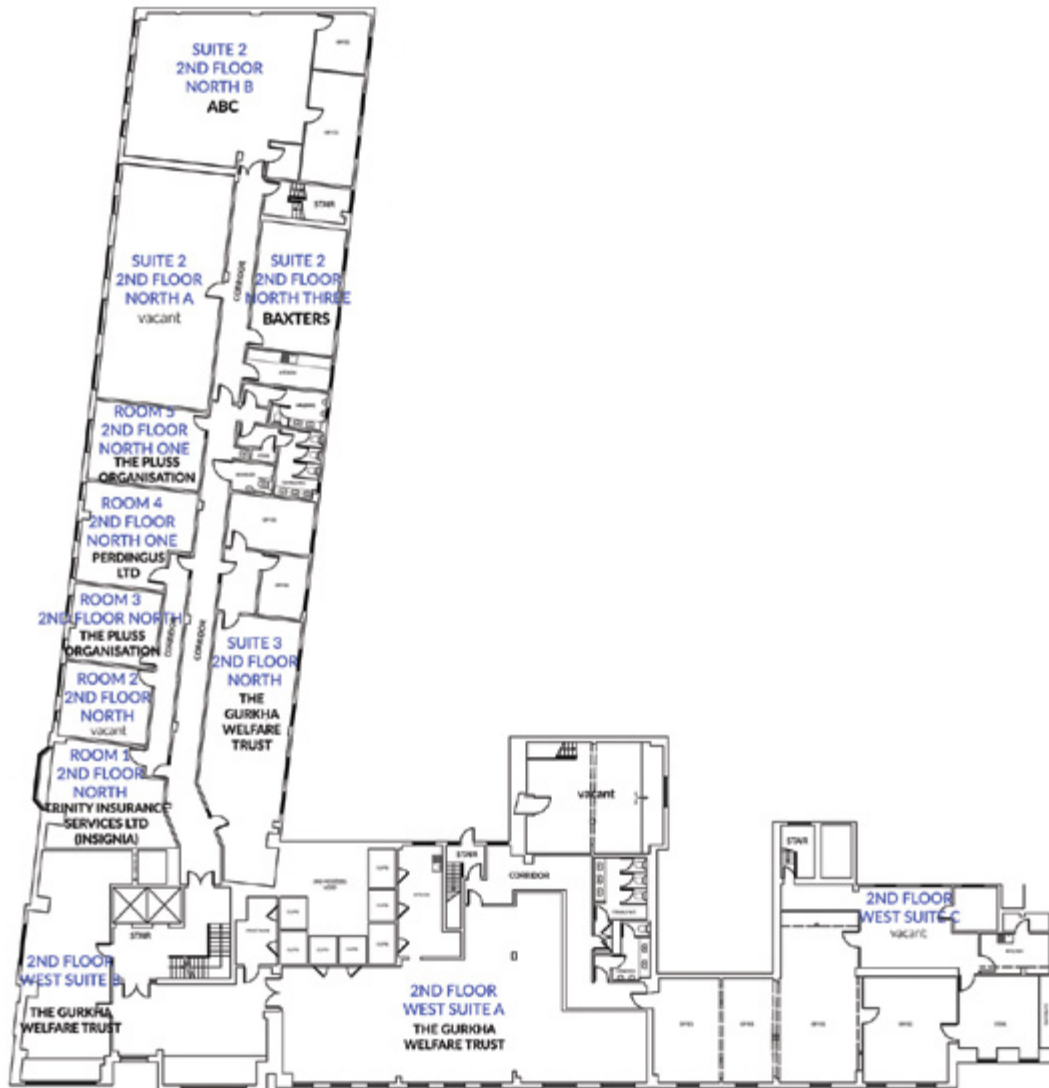

## Second Floor

*Particulars available on request for individual units.*

For specific details relating to rent, business rates and permitted use please contact Myddelton & Major  
**01722 337577**  
[commercial@myddeltonmajor.co.uk](mailto:commercial@myddeltonmajor.co.uk)



# MAKE CROSS KEYS YOUR HOME... IN THE HEART OF SALISBURY

Cross Keys House provides high quality open plan offices.

The accommodation is arranged as individual office suites, which may be combined for larger requirements.

## ABOUT SALISBURY

Salisbury is an historic Cathedral City in Central Southern England with a vibrant proactive business community.

Road communications are well served to London via A303 (M3) (88 miles); Southampton via A36 (M27) (24 miles); Bristol via A36 (54 miles); Exeter via A303 (91 miles) (Source: The AA). Parking is available on site.

Rail communications are provided by a main-line Station with frequent service to London (Waterloo) (90 minutes approx).

## GET IN TOUCH TODAY!

A NUMBER OF UNITS ARE CURRENTLY AVAILABLE AT HIGHLY ATTRACTIVE RATES TO SUIT ALL TYPES AND SIZE OF BUSINESS.

For specific details relating to rent, business rates and permitted use please contact Myddelton & Major  
**01722 337577**  
**commercial@myddeltonmajor.co.uk**

